

Built-in touchless tap

Qtoo collection

Product 250mm built-in infrared touchless tap

Tender text QTOO collection, built-in touchless tap. Manufactured in the highest quality marine grade, AISI 316 stainless steel, protecting against high levels of corrosion and securing cleaner drinking and utility water.

Re-handle®

[Re-handle your product here](#)

Re-handle® this product (does not apply to coated items) to prolong its life span up to 100 years, lowering the Global Warming potential (CO2) between 54-91% depending on the product.

Product specification Spout projection: 250mm (9 27/32")
 Rose diameter: Ø90mm (3 1/2")
 Build in depth: 69mm (2 3/4")
 Spout: preinstalled 5,7 l/min (1,5 gpm) aerator (contact sellers for other options)
 Comfort time out 2 sec.
 Security time out 30 sec.
 Automatic rinse cycle (deactivated)
 Always secure min. 140mm - 5 1/2" distance from aerator to washbasin waste
 Use with Flexbox QSF01 and connector QS3400
 Temperature control in Flexbox
 Max. work pressure 8 bar
 Including 920mm - 36 7/32" cable
 Lead free compliant
 Material: Marine grade AISI 316 stainless steel
[20-year warranty \(5 years for coated items\)](#)

Available finishes

Solid metal

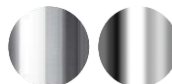

Satin steel

Polished steel

PVD

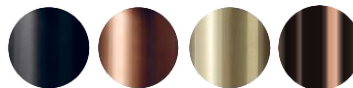

Charcoal

Copper

Brass

Bronze

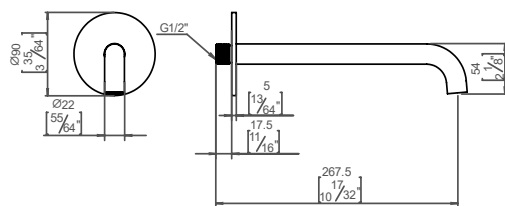

Spare parts/ accessories QSF01 - Premix Flexbox
 QS3400 - Built in spout connector

Mounting <https://dline.com/mounting-instructions/>

Product care

d line products are produced in the highest quality marine grade AISI 316 stainless steel. To sustain the unique d line finish please follow the below instructions:

- Wash down the surfaces using soapy water or mild detergent
- Always thoroughly rinse off with clean water

• To complete the cleaning procedure dry/polish the surface with a soft dry cloth
 Please do not use scouring powder, steel wool, chloride based detergents or other aggressive cleaning products as these may damage the surface.

If spots or corrosion appear on the surface it is not due to the stainless steel quality, but to impurities in the environment, aggressive conditions or improper or insufficient cleaning.

QST3290 flow rate (without aerator)

